

**ITEC 3335  
Database Development  
Fall 2018  
Homework #1**

**Communications**

(1) Send an email to the TA. The subject heading should be H1; <<Your name>>; <<Your Student ID>>, <<Your major>>

For example:

Subject: H1; Bun Yue; 0011098; IT

You should attach a recent photo of yourself of *very good* quality of *exactly* 300 pixel width and 450 pixel height. The image format should be gif, jpeg or png.

Make sure that you use *UHCL email address* in your communications with the TA and me. Email addresses other than UHCL's may be filtered by UHCL spam filter.

Do *not* copy your homework to the instructor. This is to establish a communication channel between you and the teaching assistant.

**MS Access Query**

(2) Use MS Access Query Design tool to answer the following queries for the database [world.accdb](#) (created in 2007). Take a screenshot of the Query Design as the answer for each of the following question.

UHCL Computer Lab has MS Office installed. It includes Access. Microsoft has a [four years license](#) for students on Office 365 University at \$79.99.

(a) Provide the names, regions, and GNP (in millions) of countries in which GNP is greater than 1,000,000 (millions). Display the result in descending order of GNP.

city	country	countrylanguage	Q1	Q2	Q3	Q4	Q5	Q6
Name	Region	GNP						
United States	North America	8510700						
Japan	Eastern Asia	3787042						
Germany	Western Europe	2133367						
France	Western Europe	1424285						
United Kingdom	British Islands	1378330						
Italy	Southern Europe	1161755						
China	Eastern Asia	982268						
Brazil	South America	776739						
Canada	North America	598862						
Spain	Southern Europe	553233						
India	Southern and Central Asia	447114						
Mexico	Central America	414972						
Netherlands	Western Europe	371362						
Australia	Australia and Oceania	351182						
Argentina	South America	340238						
South Korea	Eastern Asia	320749						
Russian Federation	Eastern Europe	276608						
Switzerland	Western Europe	264478						
Taiwan	Eastern Asia	256254						
Belgium	Western Europe	249704						
Sweden	Nordic Countries	226492						
Austria	Western Europe	211860						
Turkey	Middle East	210721						
Iran	Southern and Central Asia	195746						

(2) List the names of Asian countries, their GPA and life expectancies. Only list countries with a life expectancy of 75 or above. The result is displayed in the descending order of life expectancy.

city	country	countrylanguage	Q1	Q2	Q3	Q4	Q5	Q6
Name	GNP	LifeExpectancy						
Macao	5749	81.6						
Japan	3787042	80.7						
Singapore	86503	80.1						
Hong Kong	166448	79.5						
Israel	97477	78.6						
Jordan	7526	77.4						
Cyprus	9333	76.7						
Taiwan	256254	76.4						
Kuwait	27037	76.1						
*								

(3) List the city names and country names and city populations of cities with a population between 5 and 10 millions. The result is displayed in the descending order of city populations.

city.Name	country.Name	Population
Seoul	South Korea	9981619
São Paulo	Brazil	9968485
Shanghai	China	9696300
Jakarta	Indonesia	9604900
Karachi	Pakistan	9269265
Istanbul	Turkey	8787958
Ciudad de México	Mexico	8591309
Moscow	Russian Federation	8389200
New York	United States	8008278
Tokyo	Japan	7980230
Peking	China	7472000
London	United Kingdom	7285000
Delhi	India	7206704
Cairo	Egypt	6789479
Teheran	Iran	6758845
Lima	Peru	6464693
Chongqing	China	6351600
Bangkok	Thailand	6320174
Santafé de Bogotá	Colombia	6260862
Rio de Janeiro	Brazil	5598953
Tianjin	China	5286800
Kinshasa	Congo, The Democratic R	5064000
Lahore	Pakistan	5063499

(4) List the city names, country names, and populations of cities in which Japanese is a declared language of the country. Include only cities with 4 million or more population. Note that the display column names are not the same as the column names of the source tables.

City	Country	Population
Rio de Janeiro	Brazil	5598953
São Paulo	Brazil	9968485
Tokyo	Japan	7980230
New York	United States	8008278

(5) List the city names, country names, and populations of cities in which English is an official language of the country. Include only cities with 4 million or more population.

City	Population	Country
New York	8008278	United States
London	7285000	United Kingdom

(6) When executed, the query displays a pop-up window for user to input a country name, such as 'United States'.

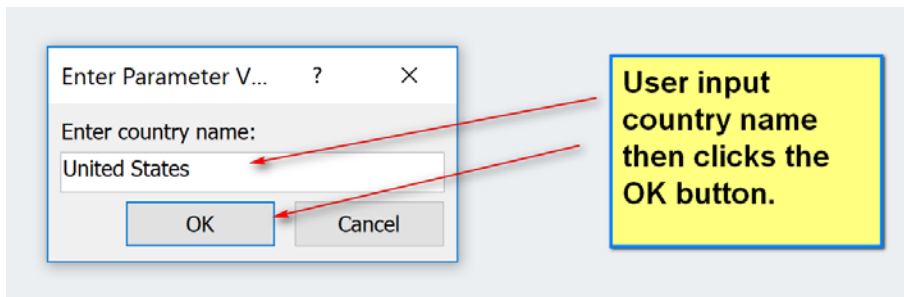

It then displays the names and populations of the cities with a population of 1 million or more in the country.

City	Population
New York	8008278
Los Angeles	3694820
Chicago	2896016
Houston	1953631
Philadelphia	1517550
Phoenix	1321045
San Diego	1223400
Dallas	1188580
San Antonio	1144646

Turn in a zipped file containing the following a docx file containing the screenshot of your query designs.

Submit the homework through Blackboard. Naming convention should be the same for all homework submission: h<assignment number>\_itec3335\_<<sid>>\_<lastname>.<extension>. For example, H1\_itec3335\_0111006\_Bond\_Jane.pdf.